

Tube & Pipe

Eagle Components offers a full line of quality tubing and pipe in a variety of sizes. Most of these sizes are available in aluminum, stainless steel, carbon steel, and galvanized steel with a standard length of 20 ft.

When ordering, please specify tube or pipe size, wall thickness, and material of construction. Many sizes and types are available for prompt delivery. Some common sizes are shown in the table at right. Additional sizes are available. Please call for details.



Tube Sizes	Gauge	Pipe Sizes	Schedule
1-1/2" Tube	14, 16 Ga	1" Pipe	Sch 40
1-3/4" Tube	14, 16 Ga	1-1/4" Pipe	Sch 40
2" Tube	11, 14, 16 Ga	1-1/2" Pipe	Sch 10, 40
2-1/8" Tube	16 Ga	2" Pipe	Sch 5, 10, 40
2-1/4" Tube	11, 14, 16 Ga	2-1/2" Pipe	Sch 10, 40
2-1/2" Tube	11, 14, 16 Ga	3" Pipe	Sch 5, 10, 40, 80
3" Tube	11, 14, 16 GA	3-1/2" Pipe	Sch 5, 10, 40
3-1/2" Tube	11, 14, 16 Ga	4" Pipe	Sch 5, 10, 40
4" Tube	11, 14, 16 Ga	5" Pipe	Sch 10, 40
4-1/2" Tube	11, 14 Ga	6" Pipe	Sch 10, 40
5" Tube	11, 14, 16 Ga	8" Pipe	Sch 10
6" Tube	11, 14 Ga		
8" Tube	11, 14 Ga		

Standard Elbows

Pipe and tube bends in multiple sizes and materials are readily available from Eagle Components. Aluminum and stainless steel are the most common materials, but carbon and galvanized steel bends can be provided. The table at right shows most common sizes. Many of these are in stock for prompt delivery. When ordering, please refer to drawing below. Information required includes material of construction, outer diameter, wall thickness, degree of bend, and center line radius (CLR in the drawing).

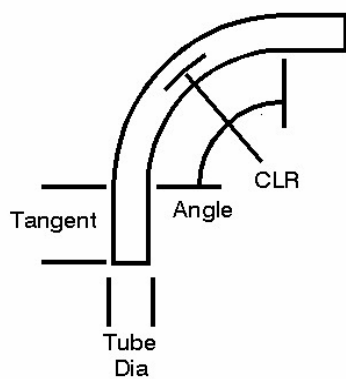

Tube Size	Pipe Size	Outer Diameter	Guage / Schedule	Center Line Radii (Inches)	Standard Tangents
1"		1"	11, 14 Ga	3, 6	4"
	1"	1.315"	Sch 5, 10, 40	3, 5	4"
1-1/4"		1.25"	11, 14 Ga	3, 7.25	4"
	1-1/4"	1.66"	Sch 5, 10, 40	6.25	4"
1-1/2"		1.5"	11, 14, 16 Ga	2.5, 5, 6, 7.5, 9, 12, 18, 24, 30, 36, 48	4"
1-3/4"		1.75"	11, 14, 16 Ga	2.5, 8, 9, 15, 24, 30, 36, 48	4"
	1-1/2"	1.9"	Sch 10, 40	5, 6, 7.5, 9, 10, 12, 18, 24, 30, 36, 48	4"
2"		2"	11, 14, 16 Ga	6, 8.5, 9, 10, 12, 18, 24, 30, 36, 48	4"
2-1/4"		2.25"	11, 14, 16 Ga	3, 9, 12, 15, 17, 24, 30, 36, 48	4-1/2"
	2"	2.375"	Sch 5, 10, 40	6, 7.5, 9, 10, 12, 17, 24, 30, 36	4"
2-1/2"		2.50"	11, 14, 16 Ga	4, 6, 9, 12, 15, 17, 24, 30, 36, 48	5"
	2-1/2"	2.875"	Sch 5, 10, 40	9, 12.5, 17, 24, 30, 36	5"
3"		3"	11, 14, 16 Ga	4, 7.5, 9, 10, 12, 15, 18, 24, 30, 36, 48, 52	6"
3-1/2"	3"	3.5"	11, 14, 16 Ga, Sch 5, 10, 40	12, 15, 16, 18, 20, 24, 30, 36, 48	7" (6" pipe)
4"	3-1/2"	4"	11, 14, 16 Ga, Sch 5, 10, 40	6, 10, 12, 18, 20, 24, 30, 32, 36, 48	8" (7" pipe)
4-1/2"	4"	4.5"	11, 14 Ga, Sch 5, 10, 40	9, 12, 16, 18, 20, 24, 30, 32, 36, 48	9" (8" pipe)
5"		5.0"	11, 14 Ga	7.5, 12.5, 24, 30, 36, 42, 48, 60, 72	10"
	5"	5.563"	Sch 10, 40	20, 30, 36, 42, 48, 60	10"
6"		6"	11, 14 Ga	9, 15, 24, 30, 36, 48, 60, 72	12"
	6"	6.625"	Sch 10, 40	24, 30, 36, 42, 48, 60, 72	12"
8"		8"	11, 14 Ga	20, 48, 60, 72	16"
	8"	8.625"	Sch 10, 40	24, 32, 40, 48, 60, 72	16"

Extended Wear Elbows

Eagle Components offers extended wear elbows for conveying highly abrasive materials, including Wear-Backed Elbows, Ceramic-Backed Elbows, and Ceramic-Lined Elbows.

Wear-Backed Elbows are offered in a variety of designs, all using the basic concept of an additional cavity on the outside wall of the elbow. When the core elbow wears through, the cavity fills with material, which wears against itself, thereby extending the component's life.

Ceramic-Backed Elbows have a 1/2" thick layer of ceramic compound applied to the outside radius of the core elbow. This jacket and the core elbow are then wrapped in an exterior material to maintain the elbow's strength.

Ceramic-Lined Elbows have an inner coating of specially formulated ceramic material, creating a very hard, slippery surface. This coating has hardness of 5 to 6 on the Mohs scale.



Hammertek Elbows

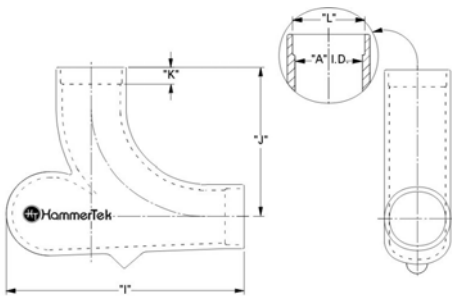

Eagle Components also provides the Hammertek "Smart" Elbow. These elbows are designed to create a gently rotating ball of material in the vortice chamber, virtually eliminating impact with the elbow walls. They are available with flanged fittings, or with tube OD ends that can be connected with special compression couplers.

